

SEALMASTER® RPB Bearings

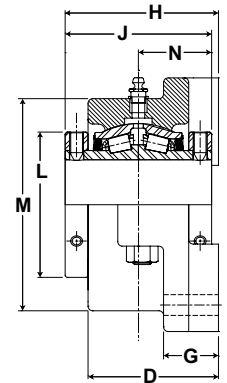

- Rolling Elements:** Tapered Roller
- Housing:** Cast Iron Four Bolt Flange
- Self Alignment:** +/- 3 Degrees
- Lock:** Setscrew, Double Collar
- Seal:** Felt
- Optional Seal:** Single Lip Contact
- Temperature:** -20°F to 220°F

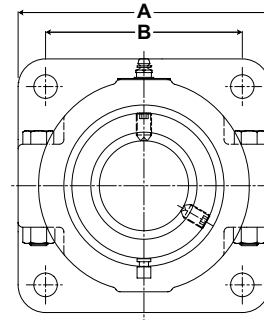

RFB Series Four-Bolt Flange Units

Bore Diameter		Part No.	Bearing Insert No.	Basic Dynamic Rating lb/N	Dimensions inch / mm										Unit Wt. lb/kg	
					A	B	B.C.	D	G	H	J	L	M	N		Bolt Size
inch	mm															
1 3/16		RFB-103	RCI-103	2975	4	2 7/8	4 1/16	2 5/16	1	2 13/16	2 25/32	2 1/4	3 1/4	1 25/64	3/8	6.0
1 1/4		RFB-104	RCI-104	13233	101.6	73.0	103.2	58.7	25.4	71.4	70.6	57.2	82.6	35.3		2.72
1 3/8	35	RFB-106	RCI-106	4760	4 5/8	3 1/2	4 61/64	2 9/16	1	3 1/16	3	2 5/8	3 3/4	1 1/2	1/2	8.1
1 7/16		RFB-35MM	RCI-35MM	21174	117.5	88.9	125.8	65.1	25.4	77.8	76.2	66.7	95.3	38.1		3.67
1 1/2	40	RFB-108	RCI-108	6140	5 3/8	4 1/8	5 53/64	2 15/16	1 3/16	3 1/2	3 3/8	2 7/8	4 1/2	1 11/16	1/2	12.3
1 5/8		RFB-40MM	RCI-40MM	27312	136.5	104.8	148.0	74.6	30.2	88.9	85.7	73.0	114.3	42.9		5.58
1 11/16		RFB-110	RCI-110													
1 3/4	45	RFB-112	RCI-112	8070	5 5/8	4 3/8	6 3/16	3 1/16	1 3/16	3 5/8	3 1/2	3 1/4	4 3/4	1 3/4	1/2	14.5
1 15/16		RFB-45MM	RCI-45MM	35897	142.9	111.1	157.2	77.8	30.2	92.1	88.9	82.6	120.7	44.5		6.58
		RFB-115	RCI-115													
		RFB-50MM	RCI-50MM													
2	50	RFB-200	RCI-200													
		RFB-55MM	RCI-55MM	8570	6 1/4	4 7/8	6 57/64	3 1/4	1 3/8	3 7/8	3 3/4	3 5/8	5 1/4	1 7/8	5/8	19.0
2 3/16		RFB-203	RCI-203	38121	158.8	123.8	175.0	82.6	34.9	98.4	95.3	92.1	133.4	47.6		8.62
2 1/4	60	RFB-204	RCI-204	9030	6 7/8	5 3/8	7 39/64	3 9/16	1 1/2	4 3/16	4	3 15/16	5 3/4	2	5/8	24.0
2 7/16		RFB-60MM	RCI-60MM	40167	174.6	136.5	193.3	90.5	38.1	106.4	101.6	100.0	146.1	50.8		10.89
2 1/2		RFB-207	RCI-207													
		RFB-208	RCI-208													
	65	RFB-65MM	RCI-65MM													
2 11/16	70	RFB-211	RCI-211	9630	7 3/4	6	8 31/64	3 15/16	1 5/8	4 11/16	4 1/2	4 23/32	6 1/2	2 1/4	3/4	33.4
2 3/4		RFB-212	RCI-212	42836	196.9	152.4	215.5	100.0	41.3	119.1	114.3	119.9	165.1	57.2		15.15
		RFB-70MM	RCI-70MM													
2 15/16		RFB-215	RCI-215													
		RFB-215	RCI-215													
	75	RFB-75MM	RCI-75MM													
	3	RFB-300	RCI-300													
3 3/16	80	RFB-80MM	RCI-80MM	15320	9 1/4	7	9 29/32	4 1/2	1 7/8	5 1/4	5	5 7/16	8	2 1/2	3/4	57.4
3 1/4		RFB-303	RCI-303	68147	235.0	177.8	251.6	114.3	47.6	133.4	127.0	138.1	203.2	63.5		26.04
		RFB-304	RCI-304													
3 7/16		RFB-85MM	RCI-85MM													
3 1/2		RFB-307	RCI-307													
	90	RFB-90MM	RCI-90MM													
	95	RFB-95MM	RCI-95MM													
3 15/16	100	RFB-315	RCI-315	20980	10 1/4	7 3/4	10 61/64	5 5/8	2 1/8	6 1/2	6 1/4	5 15/16	8 7/8	3 1/8	7/8	81.8
		RFB-100MM	RCI-100MM	93324	260.4	196.9	278.2	142.9	54.0	165.1	158.8	150.8	225.4	79.4		37.10
4		RFB-400	RCI-400													
	105	RFB-105MM	RCI-105MM													

Metric dimensions for reference only.
 Not all parts are available from stock. Please contact customer service for availability (800) 626-2120.
 For more information on bearing capabilities outside of our standard offering, please contact Application Engineering (800) 626-2093.